

# SECTION 1.0

## IEPA Forms



# Illinois Environmental Protection Agency

1021 North Grand Avenue East • P.O. Box 19276 • Springfield • Illinois • 62794-9276 • (217) 782-3397

## 39(i) Certification for Operating a Waste Management Facility

Pursuant to 415 ILCS 5/39(i), prior to issuing any RCRA permit, or any permit for a waste storage site, sanitary landfill, waste disposal site, waste transfer station, waste treatment facility, waste incinerator, clean construction or demolition debris fill operation, or used tire storage site, the Illinois EPA must conduct an evaluation of the prospective owner's or operator's prior experience in waste management operations, clean construction or demolition debris fill operations, and tire storage site management. As part of that evaluation please complete and submit this form with your permit application.

This form may be completed online and saved locally before printing, signing and submitting it to the Illinois EPA at the address below. If the form is completed manually, please type or print clearly.

Illinois Environmental Protection Agency  
Division of Land Pollution Control - #33  
39(i) Certification  
1021 North Grand Avenue East  
P.O. Box 19276  
Springfield, IL 62794-9276

### I. Applicant Information

Site Name Zion Landfill IEPA BOL No.: 0978020002

Site Address 701 Green Bay Road

City: Zion State: IL Zip Code: 60099-9564

Permit Numbers (if applicable): 1995-343-LFM

#### Owner

#### Operator

Owner Name: Zion Landfill, Inc. Operator Name: Zion Landfill, Inc.

Street Address: 701 Green Bay Road Street Address: 701 Green Bay Road

City: Zion State: IL Zip: 60099 City: Zion State: IL Zip: 60099

Is this 39(i) certification for the owner or the operator?

Owner  Operator  Owner and operator are the same entity

### II. Officers and Employees with Site Responsibility

Unless the owner and operator are the same entity, a separate 39(i) form must be submitted for both the owner and operator. Persons operating under the authority of the owner should be listed on the owner's 39(i) form and persons operating under authority of the operator should be listed on the operator's 39(i) form.

A. Officers: List the name and title of all officers of the owner or operator that will have personal involvement or active participation in the operation or management of the site or facility for which the application is submitted.

Name	Title
Michael Stoeckigt	Area Vice President

B. Employees: List the name and title of each employee of the owner or operator that will have personal involvement or active participation in the overall operation or management of the site or facility for which the application is submitted (e.g. site managers, site engineers, and other persons who direct or control the overall day-to-day management of the operation, but not persons whose duties are exclusively limited to equipment operation, labor, or similar non-managerial functions).

Name	Title
Timothy D. Curry	Area Landfill Director
Mark Bingham	General Manager
John Hagopian	Operations Manager

### III. Owner, Operator, Officer, and Employee Information

#### A. Prior Conduct Identification

The applicant must answer each of the following questions for every owner or operator, and for any officer or employee identified under Section II. If the answer to any of the following questions is affirmative, the applicant must complete an Attachment A for each person for whom the answer is affirmative and include a copy of each final administrative or judicial determination that required an affirmative response. If the information for each owner, operator, officer, and employee has not changed since the applicant's last submission of a 39(i) certification, the applicant can skip to Section III(C), below.

- 1) Has there been a finding that any person named in Section II violated federal, State, or local laws, regulations, standards, or ordinances in the operation of one or more waste management facilities or sites, clean construction or demolition debris fill operation facilities or sites, or tire storage sites?  Yes  
 No
- 2) Has any person named in Section II ever been convicted in this or another State of any crime which is a felony under the laws of this State, or convicted of a felony in a federal court; or convicted in this or another state or federal court of any of the following crimes: forgery, official misconduct, bribery, perjury, or knowingly submitting false information under any environmental law, regulation, or permit term or condition?  Yes  
 No
- 3) Has there been a finding against any person named in Section II of gross carelessness or incompetence in handling, storing, processing, transporting or disposing of waste, clean construction or demolition debris, or used or waste tires, or a finding of gross carelessness or incompetence in using clean construction or demolition debris as fill?  Yes  
 No

#### B. Pending Proceedings

The applicant must answer each of the following questions for every owner or operator, and for any officer or employee identified in Section II. If the answer to any of the following questions is affirmative, the applicant must complete an Attachment A for each person for whom the answer is affirmative and provide information identified in Attachment A regarding the pending proceeding.

1. Is there any proceeding currently pending against any person named in Section II that could result in a conviction or finding described in subsection A, above?  Yes  
 No
2. Is there any proceeding currently pending against any person named in Section II that could result in the reversal of a conviction or finding described in subsection A, above?  Yes  
 No

#### C. Prior Application Information

If (i) the applicant has previously submitted the Attachments required pursuant to subsections A and B above and (ii) the Attachments previously submitted are still complete, true, and correct, then the applicant does not need to include Attachments with this submission if the following box is checked:

By checking this box, I affirm that the Attachments previously submitted are still complete, true, and correct and wish to incorporate them into this Certification.

If the above box is checked, identify the application that contains the previously submitted Attachments that are complete, true, and correct.

## Authorization for Release of Information

This Certification must be signed by an officer of the applicant.

The undersigned authorizes any representative of the Illinois Environmental Protection Agency bearing this release to obtain any information from the Illinois State Police pertaining to the criminal records of the applicant and hereby directs the Illinois State Police to release such information upon request of the bearer. The undersigned authorizes a review of and full disclosure of all records, or any part thereof, concerning the applicant's criminal records by and to a duly authorized agent of the Illinois Environmental Protection Agency, whether the records are of public, private, or confidential nature. The intent of this authorization is to give consent for full and complete disclosure of the applicant's criminal records.

The undersigned fully understands that any information which is developed directly or indirectly, in whole or in part, as a result of this authorization will be considered in determining whether a permit shall be issued by the Illinois Environmental Protection Agency under the Environmental Protection Act [415 ILCS 5]. The undersigned further agrees to release the Illinois State Police and the Illinois Environmental Protection Agency, its agents and designees under this release, from any and all liability which may be incurred as a result of compliance with this authorization for release of information.

## Certification Statements

I certify under penalty of law that the information submitted, including information on any Attachments submitted as part of or incorporated into this Certification, is, to the best of my knowledge and belief, true, accurate, and complete. I am aware that there are significant penalties for submitting false information, including the possibility of fine and imprisonment for knowing violations.

**Any person who knowingly makes a false, fictitious, or fraudulent material statement, orally or in writing, to the Illinois EPA commits a Class 4 felony. A second or subsequent offense after conviction is a Class 3 felony. (415 ILCS 5/44(h))**

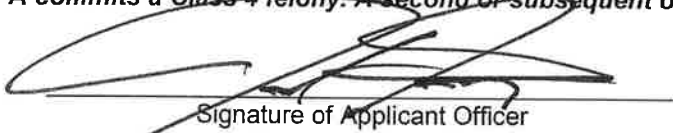

Signature of Applicant Officer

Michael Stoeckigt

Printed Name

7-18-22

Date

Area Vice President

Title



# Illinois Environmental Protection Agency

1021 North Grand Avenue East • P.O. Box 19276 • Springfield • Illinois • 62794-9276 • (217) 782-3397

## General Application for Permit (LPC - PA1)

This form must be used for any application for permit from the Bureau of Land, except for landscape waste composting or hazardous waste management facilities regulated in accordance with RCRA, Subtitle C. One original, and two copies, or three if applicable, of all permit application forms must be submitted. Attach the original and appropriate number of copies of any necessary plans, specifications, reports, etc. to fully support and describe the activities and modifications being proposed. Attach sufficient information to demonstrate the compliance with all regulatory requirements. Incomplete applications will be rejected. Please refer to the instructions for further guidance. **Note: Applicants must provide a physical address; the post office will not deliver a certified letter (final action letter) to a P.O. Box only. Please provide an extended ZIP+4 code for the site identification and owner/operator information.**

You may complete this form online, save a copy locally, print, sign and submit it to the Bureau of Land at the address below. Note: Hand-delivered permit applications must be delivered between 8:30 am and 5:00 pm, Monday through Friday (excluding State holidays) to:

Bureau of Land, Permit Section, Mail Code #33  
1021 North Grand Avenue East, P.O. Box 19276  
Springfield, IL 62794-9276

[Instructions](#)

### I. Site Identification

Site Name: Zion Landfill IEPA BOL No.: 0978020002  
Street Address: 701 Green Bay Road P.O. Box: \_\_\_\_\_  
City: Zion State: IL Zip + 4: \*60099-9564 \*Notification letters will not be sent without a 9-digit zip code. County: Lake  
Existing DE/OP Permit Numbers (if applicable): 1995-343-LFM

### II. Applicant Identification

#### Owner

Name: Zion Landfill, Inc.  
Street Address: 701 Green Bay Road  
PO Box: \_\_\_\_\_  
City: Zion State: IL  
Zip + 4: 60099-9564 Phone: \_\_\_\_\_  
Contact: Mark Bingham  
Email Address: mark.bingham@glenv.com  
FEIN ID No. 36-4349388

#### Operator (if Different)

Name: \_\_\_\_\_  
Street Address: \_\_\_\_\_  
PO Box: \_\_\_\_\_  
City: \_\_\_\_\_ State: \_\_\_\_\_  
Zip + 4: \_\_\_\_\_ Phone: \_\_\_\_\_  
Contact: \_\_\_\_\_  
Email Address: \_\_\_\_\_  
FEIN ID No. \_\_\_\_\_

Agency correspondence mailed to:

Owner  Operator  Other - Explain: \_\_\_\_\_

#### TYPE OF SUBMISSION/REVIEW PERIOD:

- New Landfill/180 days (35 IAC Part 813)
- Landfill Expansion/180 days (35 IAC Part 813)
- Sig. Mod. to Operate/90 days (35 IAC Part 813)
- Other Sig. Mod./90 days (35 IAC Part 813)
- Renewal of Landfill/90 days (35 IAC Part 813)
- Development/90 days (35 IAC Part 807)
- Operating/45 days (35 IAC Part 807)
- Operating/90 days (35 IAC Part 848)
- Supplemental/90 days (35 IAC Part 807)
- Permit Transfer/90 days (35 IAC Part 807)
- Renewal of Experimental Permit (35 IAC Part 807)

#### TYPE OF FACILITY:

- Landfill
- Land Treatment
- Transfer Station
- Treatment Facility
- Storage
- Incinerator
- Composting
- Recycling/Reclamation
- Used Tire Storage/Processing Facility
- Other (Specify)

#### TYPE OF WASTE:

- General Municipal Refuse
- Hazardous
- Special (Non-Hazardous)
- Chemical Only (exec. putrescible)
- Inert Only (exec. chem. & putrescible)
- Used Oil
- Potentially Infectious Medical Waste
- Landscape/Yard Waste
- Used Tires
- Other (Specify)

This Agency is authorized to require this information under Section 4 and Title X of the Environmental Protection Act (415 ILCS 5/4, 5/39). Failure to disclose this information may result in: a civil penalty of not to exceed \$50,000 for the violation and an additional civil penalty of not to exceed \$10,000 for each day during which the violation continues (415 ILCS 5/42).

IL 532-1857

LPC 350 Rev. 10/2018

**III. Description of this Permit Request:** (Note: The box below will expand as needed)

Requests Development Permit for a vertical and horizontal expansion of Zion Landfill.

**IV. Completeness Requirements**

1. Have all required public notice letters been mailed in accordance with the LPC-PA16 instructions? Yes  No  N/A

(If so, provide a list of those recipients of the required public notice letters for Illinois EPA retention.  
Such retention shall not imply any Illinois EPA review and/or confirmation of the list.)

**Public Notice Recipients**

Name: <u>Honorable Joyce Mason</u>	Title: <u>State Representative - 61st District</u>
Street Address: <u>36100 Brookside Dr., Suites LL 60</u>	P.O. Box: _____
City: <u>Gurnee</u> State: <u>IL</u>	Zip Code: <u>60031</u>
Name: <u>Honorable Melinda Bush</u>	Title: <u>State Senate - 31st District</u>
Street Address: <u>10 North Lake Street, Suite 112</u>	P.O. Box: _____
City: <u>Grayslake</u> State: <u>IL</u>	Zip Code: <u>60030</u>
Name: <u>Mr. Eric F. Rinehart</u>	Title: <u>Lake County State's Attorney</u>
Street Address: <u>18 N County Street</u>	P.O. Box: _____
City: <u>Waukegan</u> State: <u>IL</u>	Zip Code: <u>60085</u>
Name: <u>Ms. Gina Roberts</u>	Title: <u>Lake County District 4 Board Member</u>
Street Address: <u>18 North County Street, 10th Floor</u>	P.O. Box: _____
City: <u>Waukegan</u> State: <u>IL</u>	Zip Code: <u>60085</u>
Name: <u>Ms. Sheryl Spooner</u>	Title: <u>City of Zion Clerk</u>
Street Address: <u>2828 Sheridan Road</u>	P.O. Box: _____
City: <u>Zion</u> State: <u>IL</u>	Zip Code: <u>60099</u>
Name: <u>Ms. Robin M. O'Connor</u>	Title: <u>Lake County Clerk</u>
Street Address: <u>18 N County Street, Room 101</u>	P.O. Box: _____
City: <u>Waukegan</u> State: <u>IL</u>	Zip Code: <u>60085</u>
Name: <u>Ms. Brook Craig</u>	Title: <u>City of Benton Clerk</u>
Street Address: <u>1403 S. Main Street</u>	P.O. Box: _____
City: <u>Benton</u> State: <u>IL</u>	Zip Code: <u>62812</u>
Name: <u>Ms. Evelyn Hoselton</u>	Title: <u>Village of Wadsworth Clerk</u>
Street Address: <u>14155 West Wadsworth Road</u>	P.O. Box: _____
City: <u>Wadsworth</u> State: <u>IL</u>	Zip Code: <u>60083</u>
Name: <u>Ms. Julie Rittenhouse</u>	Title: <u>Village of Winthrop Harbor Clerk</u>
Street Address: <u>830 Sheridan Road</u>	P.O. Box: _____
City: <u>Winthrop Harbor</u> State: <u>IL</u>	Zip Code: <u>60096</u>
Name: <u>Ms. Mary Jo McDonald</u>	Title: <u>Village of Beach Park Clerk</u>
Street Address: <u>11270 W. Wadsworth Road</u>	P.O. Box: _____
City: <u>Beach Park</u> State: <u>IL</u>	Zip Code: <u>60099</u>

Name: <u>Ms. Regi Bachochin</u>	Title: <u>Kenosha County Clerk</u>
Street Address: <u>1010 56th Street</u>	P.O. Box: _____
City: <u>Kenosha</u> State: <u>WI</u>	Zip Code: <u>53140</u>
Name: <u>Ms. Jane C. Snell</u>	Title: <u>Village of Pleasant Prairie Clerk</u>
Street Address: <u>9915 39th Avenue</u>	P.O. Box: _____
City: <u>Pleasant Prairie</u> State: <u>WI</u>	Zip Code: <u>53158</u>

- |  | Yes                              | No                               | N/A                              |
|--|----------------------------------|----------------------------------|----------------------------------|
| 2. a. Is the Siting Certification Form (LPC-PA8) completed and enclosed?   | <input checked="" type="radio"/> | <input type="radio"/>            | <input type="radio"/>            |
| b. Is siting approval currently under litigation?  | <input type="radio"/>            | <input checked="" type="radio"/> | <input type="radio"/>            |
| 3. a. Is a closure, and if necessary a post-closure plan covering these activities being submitted, or   | <input checked="" type="radio"/> | <input type="radio"/>            | <input type="radio"/>            |
| b. has one already been approved?  | <input type="radio"/>            | <input type="radio"/>            | <input checked="" type="radio"/> |
| If yes, provide the permit number: _____   |                                  |                                  |                                  |
| 4. a. For operating waste disposal sites, only: Has any employee, owner, operator, officer or director of the owner or operator had a prior conduct certification denied, canceled or revoked?   | <input type="radio"/>            | <input checked="" type="radio"/> | <input type="radio"/>            |
| b. Have you included a demonstration of how you comply or intend to comply with 35 Ill. Adm. Code 745?   | <input checked="" type="radio"/> | <input type="radio"/>            | <input type="radio"/>            |
| 5. a. For waste disposal sites, only: Is the property for the facility held in a beneficial trust?   | <input type="radio"/>            | <input checked="" type="radio"/> | <input type="radio"/>            |
| b. If yes, is a beneficial trust certification form (LPC-PA9) completed and enclosed?  | <input type="radio"/>            | <input type="radio"/>            | <input checked="" type="radio"/> |
| 6. a. Does the application contain information or proposals regarding the hydrogeology; groundwater monitoring, modeling or classification; a groundwater impact assessment; or vadosezone monitoring for which you are requesting approval?   | <input checked="" type="radio"/> | <input type="radio"/>            | <input type="radio"/>            |
| b. If yes, have you submitted a third copy of the application (4 total) and supporting documents?  | <input checked="" type="radio"/> | <input type="radio"/>            | <input type="radio"/>            |
| 7. Has the required 39(i) certification been attached? A 39(i) certification must be submitted with information concerning the following persons or entities:  |                                  |                                  |                                  |
| a. the owner of the business entity applying for the permit;   | <input checked="" type="radio"/> | <input type="radio"/>            | <input type="radio"/>            |
| b. the operator of the business entity applying for the permit;  | <input checked="" type="radio"/> | <input type="radio"/>            | <input type="radio"/>            |
| c. each employee or officer of the owner or operator who signed the permit application or has managerial authority at the site; and  | <input type="radio"/>            | <input type="radio"/>            | <input checked="" type="radio"/> |
| d. any additional owner, operator, or officer or employee of the owner or operator from whom a certification is requested by the Illinois EPA, including any officer or employee who will be responsible for overseeing or implementing regulated activities governed by the permit. | <input type="radio"/>            | <input type="radio"/>            | <input checked="" type="radio"/> |
| If no, then complete this certification as indicated.  |                                  |                                  |                                  |

**V. Signatures:**

Original signatures are required. Signature stamps or applications transmitted electronically or by FAX are not acceptable.

All applications shall be signed by the person designated below as a duly authorized representative of the owner an/or operator. A printed name for each signature should also be provided.

- Corporation - By a principal executive officer of the level of vice-president or above.
- Partnership or Sole Proprietorship - By a general partner or the proprietor, respectively.
- Government - By either a principal executive officer or a ranking elected official.

A person is a duly authorized representative of the owner and operator only if:

1. They meet the criteria above or the authorization has been granted in writing by a person described above; and
2. Is submitted with this application (a copy of a previously submitted authorization can be used).

I hereby affirm that all information contained in this application is true and accurate to the best of my knowledge and belief. I do herein swear that I am a duly authorized representative of the owner/operator and I am authorized to sign this permit application form.

**Any person who knowingly makes a false, fictitious, or fraudulent material statement, orally or in writing, to the Illinois EPA commits a Class 4 felony. A second or subsequent offense after conviction is a Class 3 felony. (415 ILCS 5/44(h))**

 _____ Owner Signature	<u>7-18-22</u> _____ Date
<u>Michael Stoeckigt</u> _____ Printed Name	<u>Area Vice President</u> _____ Title

**Notary:** Subscribed and Sworn before me  
this 18th day of July 20 22.

My commission expires on: 02-23-2025

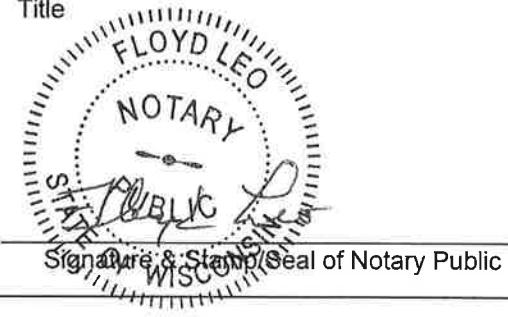

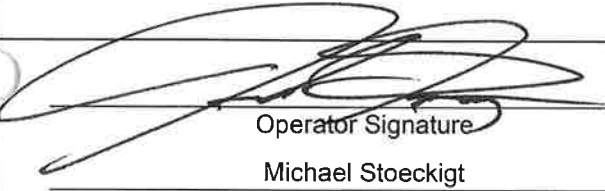
 _____ Operator Signature	<u>7-18-22</u> _____ Date
<u>Michael Stoeckigt</u> _____ Printed Name	<u>Area Vice President</u> _____ Title

**Notary:** Subscribed and Sworn before me  
this 18th day of July 20 22.

My commission expires on: 02-23-2025

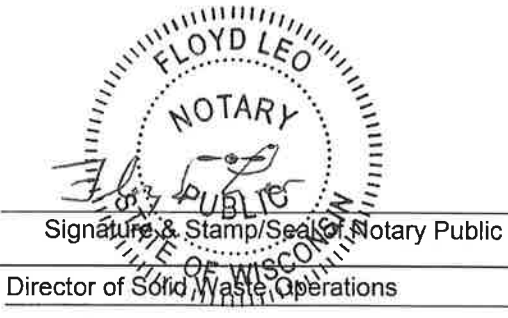

Engineer's Name: <u>Devin Moose</u>	Engineer's Title: <u>Director of Solid Waste Operations</u>
Company: <u>Aptim Environmental &amp; Infrastructure, LLC</u>	Registration Number: <u>062.044472</u>
Street Address: <u>1607 E Main St. Suite E</u>	PO Box: _____
City: <u>St. Charles</u> State: <u>IL</u>	Zip Code: <u>60174</u> Phone: <u>630-762-3308</u>
Email Address: <u>devin.moose@aptim.com</u>	
License Expiration Date: <u>Nov 30, 2023</u>	

Signature:   
\_\_\_\_\_  
Date: 7/18/2022

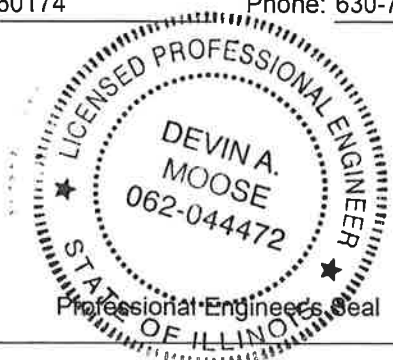





Bureau of Land • 1021 North Grand Avenue East • P.O. Box 19276 • Springfield • Illinois • 62794-9276

## Application for Permit to Develop A Nonhazardous Landfill (LPC-PA2)

This form is to be used for the initial development of a landfill, a major expansion that is beyond the boundaries of areas previously approved on a development permit or for major revisions (i.e., gas collection, leachate collection, etc.) that may impact the development permit. Other modifications to existing facilities would only require a significant modification to the existing permit and use of the General Form (LPC-PA1) with the notification form (LPC-PA16). Note: Hand-delivered Permit applications must be delivered between 8:30 am and 5:00 pm, Monday through Friday (excluding State holidays) to:

Bureau of Land, Permit Section, Mail Code #33  
1021 North Grand Avenue East, P.O. Box 19276  
Springfield, IL 62794-9276

You may also complete this form online, save a copy locally, print, sign and submit it to the Bureau of Land, Permit Section at the above address.

### I. Site Identification

Site Name: Zion Landfill IEPA BOL No.: 0978020002  
Street Address: 701 Green Bay Road P.O. Box: \_\_\_\_\_  
City: Zion State: IL Zip + 4: 60099-9564 \*Notification letters will not be sent without a 9-digit zip code. County: Lake

Existing DE/OP Permit Numbers (if applicable): 1995-343-LFM

### II. Applicant Identification

1.	Owner	Operator (if different)
Name:	<u>Zion Landfill, Inc.</u>	Name: _____
Street Address:	<u>701 Green Bay Road</u>	Street Address: _____
PO Box:	_____	PO Box: _____
City:	<u>Zion</u> State: <u>IL</u>	City: _____ State: _____
Zip + 4:	<u>60099-9564</u> Phone: _____	Zip + 4: _____ Phone: _____
Contact:	<u>Mark Bingham</u>	Contact: _____
Email Address:	<u>mark.bingham@aflenv.com</u>	Email Address: _____
FEIN ID No.	<u>36-4349388</u>	FEIN ID No. _____

#### 2. Ownership and Operator Status:

	<u>Owner</u>	<u>Operator</u>
Corporation (ILL)	<input checked="" type="checkbox"/>	<input checked="" type="checkbox"/>
Government Body	<input type="checkbox"/>	<input type="checkbox"/>
Individual	<input type="checkbox"/>	<input type="checkbox"/>
Partnership	<input type="checkbox"/>	<input type="checkbox"/>
Sole Proprietor	<input type="checkbox"/>	<input type="checkbox"/>
Governmental Body	<input type="checkbox"/>	<input type="checkbox"/>
Trust	<input type="checkbox"/>	<input type="checkbox"/>
Other:	<input type="checkbox"/>	<input type="checkbox"/>

#### Land is owned by:

Owner  Operator  
 Leased by Applicant  
 Leased by Applicant for \_\_\_\_\_ years  
 Years of Lease Remaining: \_\_\_\_\_  
 Beginning Date of Lease: \_\_\_\_\_  
 Expiration Date of Lease: \_\_\_\_\_  
 Held in Trust\* Name of Trust: \_\_\_\_\_

\*(Note: Owners of disposal sites that are held in trust must complete form LPC-PA9)

**III. Location Information**

Attach a copy of the United States Geological Survey (USGS) quadrangle map (7.5 minute quadrangle, if published) and/or a topographic map of the area which contains the site.

Quadrangle Map provided: Zion, IL and Wadsworth, IL (See Section 2.1 of this Application) 2018  
 Name Date  
 Other Map provided: Design Drawing Nos. D2 and D4 May 2022  
 Name Date

**IV. Facility Background**

This is a new unit within a new facility.

This is a new unit within an existing facility.

This is a  Horizontal and Vertical expansion of an existing unit(s) within an existing facility.

If this is a modification of an existing facility, list the environmental permits which have been issued to the facility and the dates of their issuance.

1995-343-LFM, issued March 21, 1997

Please see Appendix B for a list of permit modifications.

**V. General Facility Information:**

The following information must accompany the application. Please indicate the location in the application for the document being submitted for this application.

	<u>Page number or location of information:</u>
1. A directory of maps, plan sheets, etc. included in the application	<u>Table of Contents</u>
2. A site Plan Map(s).	<u>Drawings D2 and D4</u>
3. Narrative descriptions of the facility. The permit application shall contain a written description of the facility with supporting documentation describing the procedures and plans that will be used at the facility to comply with the requirements of 35 Ill. Adm. Code (IAC) 811 and any other applicable Parts of 35 IAC Chapter I. Such descriptions shall include, but not be limited to the following information:	<u>Section 2</u>
a. The type of waste disposal units and the types of wastes expected in each unit:	<u>Appendix R page 7</u>
b. An estimate of the maximum capacity of each unit and the rate at which waste is to be placed;	<u>Appendix N.1</u>
c. The manner in which waste will be placed and compacted to comply with 35 IAC 811.105;	<u>Appendix R page 19</u>
d. The estimated unit weight of the waste.	<u>Appendix J.1</u>
e. The length of time each unit will receive waste;	<u>App. N.1, Sec. 2.3-29</u>
f. The design period to be used for each unit;	<u>Appendix N.1</u>
g. Size of the open face area, including all information showing that slopes steeper than two to one will be stable and in compliance with 35 IAC 811.107(b);	<u>Appendix R page 20</u>
h. A description of how units will be developed to allow contemporaneous closure and stabilization pursuant to 35 IAC 811.110, 811.111.204, 811.205 or 811.322;	<u>Appendix R page 22</u>
i. A description of all equipment to be used at the facility for complying with 35 IAC 807.304;	<u>Appendix R page 3</u>
j. A litter control plan for complying with 35 IAC 811.107(k);	<u>Appendix R, Exhibit 2</u>

- k. A salvaging plan including a description of all salvage facilities and a plan for complying with 35 IAC 811.108; Appendix R page 7
- l. A description of all utilities for operation in compliance with 35 IAC 811.107(d); Appendix R page 3
- m. A boundary control plan describing how the operator will comply with the requirements of 35 IAC 811.109. Appendix R page 4
- n. A maintenance plan describing how the operator will comply with 35 IAC 811.107(c) and (e); Appendix R page 22
- o. An air quality plan describing the methods to be used to comply with the open burning requirements of 35 IAC 811.107(f) and for controlling dust in compliance with 35 IAC 811.107(g); Appendix R page 6
- p. A noise control plan describing how the operator will control noise in compliance with 35 IAC 811.107(h); Appendix R page 6
- q. An odor control plan; Appendix R page 6
- r. A vector control plan to comply with 35 IAC 811.107(i); Appendix R page 6
- s. A firefighting and fire safety plan; Appendix E
- t. A transportation plan that includes all existing and planned roads in the facility that will be used during the operation of the landfill facility; the size and type of such roads and the frequency with which they will be used; and Appendix R page 5
- u. A plan to prevent the tracking of mud onto public roadways by hauling vehicles. Appendix R page 5
- v. Other special features or relevant items. Section 2
4. The location documentation listed below should be included in the General Information Document.
- a. Documentation that the facility will operate in compliance with 35 IAC 811.102(a). 2.1-10 and App. F.5
- b. A floodplain determination containing:
- (1) Documentation that the facility is not located within the floodplain of the 100-year flood event; or 2.1-7 and App. F.2
- (2) Documentation that the facility meets the requirements of 35 IAC 811.102(b). N/A (2.1-7)
- c. Documentation from the State Historic Preservation Officer that the facility will be in compliance with 35 IAC 811.102(c). 2.1-11 and App. F.6
- d. Documentation from the Illinois Nature Preserves Commission that the facility will be in compliance with 35 IAC 811.102(c) as it relates to any Dedicated Illinois Nature Preserve. 2.1-11 and App. F.7
- e. Documentation that the facility will be in compliance with 35 IAC 811.102(d). 2.1-12 and App. F.7
- f. Documentation that the facility located within a wetland will not cause a violation of Section 404 of the Clean Water Act (35 USC 1344). 2.1-8 and App. F.3
- g. Documentation that the facility is in compliance with 35 IAC 811.102(f). 2.1-13 and Sec. 2.4
5. The surface water control plan which demonstrates compliance with 35 IAC 811.103 shall include at last the following:
- a. A copy of the approved National Pollutant Discharge Elimination System (NPDES) permit issued pursuant to 35 IAC 309 or, if a permit is pending, a copy of the NPDES permit application to discharge runoff from all disturbed areas. Appendix M.10
- b. A map showing the location of all structures affected by the surface water from disturbed areas on the facility; Drawing D13
- c. Discussions of all structures to be constructed during development of the facility and during the first five year operating period with reference to their detailed designs; and Section 2.4, App. M
- d. Estimated construction dates of all structures to be constructed beyond the first five year operating period 2.3-29

- 6. The General Information Document shall contain a description of the material to be used as daily cover:
  - a. A description of the soil to be used, including its classification and approximate hydraulic conductivity; or Appendix R page 21
  - b. Documentation that any proposed alternative materials or procedures to substitute for daily cover meet the minimum requirements of 35 IAC 811.106(b) Appendix R page 21
- 7. Legal Descriptions(s) Appendix D
- 8. Proof of Property Ownership Certification. Appendix D

**VI. Required Documentation**

The following documents are required to be included as part of this application. List any additional information

- 1. General Information Document (Refer to LPC-PA2 instructions)
- 2. Inert Waste Landfill Documents (Refer to Appendix A)
  - a. Determination
  - b. Design Report
  - c. Closure Plan
- 3. Chemical and Putrescible Waste Landfill Documents
  - a. Location Requirements (Appendix B)
  - b. Groundwater Protection Evaluation (Appendix C)
  - c. Design Description (Appendix D)
  - d. Construction Report (Appendix E)
  - e. Closure Plan and Post-Closure Care Plan (Appendix F)
  - f. Operating and Reporting Plan (Appendix G)
  - g. Others
- 4. \_\_\_\_\_  
\_\_\_\_\_
- 5. \_\_\_\_\_  
\_\_\_\_\_

Consult the Instructions for Appendices A-G for the type of information needed to be included in each document or report.



Bureau of Land • 1021 North Grand Avenue East • P.O. Box 19276 • Springfield • Illinois • 62794-9276

## Certification of Siting Approval (LPC-PA8)

This form is to be used to demonstrate compliance with the siting requirements of the Act for new pollution control facilities. Failure to submit this form when required is cause for an application to be deemed incomplete or denied.

NOTE: Please complete this form online, save a copy locally, print and submit to the Permit Section #33, at the above address.

### Siting Applicant Information

Name: Zion Landfill, Inc. Address 1: 701 Green Bay Road  
Address 2: \_\_\_\_\_ City: Zion State: IL Zip Code: 60099

### Site Information

Site Name: Zion Landfill Site Number (if assigned): 0978020002  
Nearest Municipality: City of Zion County: Lake

1. On March 22, 2022 the Zion City Council of  
(Date) (Governing body of county or municipality)

City of Zion approved the site location suitability of  
(County or Municipality)  
Zion Landfill Site 2 North Expansion as a new pollution control facility in accordance with  
(Name of Site)

Section 39.2 of the Environmental Protection Act (415 ILCS 5/39.2).

2. Because the Illinois EPA may need to verify the information on this form, please indicate a person from the unit of local government ("siting authority") whom a representative from the Illinois EPA may contact regarding this approval.

Name: Sheryl Spooner Title: City Clerk  
Address: 2828 Sheridan Road City: Zion State: IL Zip Code: 60099  
Email Address: sheryls@zion.il.us Phone: 847-746-4012

3. Identify the type of activity(ies) for which siting approval was obtained:

<input type="radio"/> Waste Storage	<input type="radio"/> Waste Transfer
<input checked="" type="checkbox"/> Sanitary Landfill	<input type="radio"/> Waste Treatment
<input checked="" type="checkbox"/> Waste Disposal	<input type="radio"/> Waste Incinerator

4. Did the local siting authority approve the acceptance of special waste?  Yes  No

Did the local siting authority approve the acceptance of hazardous waste?  Yes  No

5. Attached to this certification is a true and accurate statement of the legal descriptions of the site as it was approved by the aforementioned local siting authority. (Note: A legal description must be attached to this document, from the local siting authority, to make the application complete.)  Yes  No

This Agency is authorized to require this information under Section 4 and Title X of the Environmental Protection Act (415 ILCS 5/4, 5/39). Failure to disclose this information may result in: a civil penalty of not to exceed \$50,000 for the violation and an additional civil penalty of not to exceed \$10,000 for each day during which the violation continues (415 ILCS 5/42). This form has been approved by the Forms Management Center.

6. Did the local siting authority impose any specific conditions?  Yes  No

If so, is a copy of the conditions attached to this form?  Yes  No

(Note: These conditions are provided for information only to the Illinois EPA. The Illinois EPA is not obligated to monitor nor enforce local conditions.)

7. **This item is applicable only to landfills or disposal sites.**

Were horizontal waste disposal unit boundaries approved?  Yes  No  NA

Were vertical waste disposal unit boundaries approved?  Yes  No  NA

Was a maximum disposal capacity approved (for the facility or per disposal unit?)  Yes  No  NA

If any of the questions under #7 above were answered "yes," the siting application documents that define the subject limits must be attached to this form by the the local siting authority (e.g., legal descriptions, plan sheets, topographic drawings, etc.).

8. The undersigned has been authorized by the Zion City Council of

(Governing body of county or municipality)

City of Zion to execute this certification on their behalf.

(County or Municipality)

**Any person who knowingly makes a false, fictitious, or fraudulent material statement, orally or in writing, to the Illinois EPA commits a Class 4 felony. A second or subsequent offense after conviction is a Class 3 felony. (415 ILCS 5/44(h))**

\_\_\_\_\_  
Signature:

\_\_\_\_\_  
Date:

Sheryl Spooner  
\_\_\_\_\_  
Printed Name:

City Clerk  
\_\_\_\_\_  
Title:

Subscribed and Sworn before me this \_\_\_\_\_ day of \_\_\_\_\_ 20\_\_ .

Seal

My commission expires on: \_\_\_\_\_

\_\_\_\_\_  
Signature of Notary Public

Attachment to Question 5

The legal description of the expanded facility boundary and the facility boundary survey are attached hereto. The legal description and survey of the facility boundary were contained within Appendix D of the Siting Application submitted to the Zion City Council.

## ZION LANDFILL SITE 2 NORTH EXPANSION

### LEGAL DESCRIPTION OF EXPANDED FACILITY BOUNDARY

#### PARCEL 1:

THAT PART OF THE NORTHEAST QUARTER OF SECTION 12, TOWNSHIP 46 NORTH, RANGE 11 EAST OF THE THIRD PRINCIPAL MERIDIAN LYING EAST OF THE CENTERLINE OF GREEN BAY ROAD, IN LAKE COUNTY, ILLINOIS.

#### PARCEL 2:

THE NORTHWEST QUARTER OF SECTION 7, TOWNSHIP 46 NORTH, RANGE 12 EAST OF THE THIRD PRINCIPAL MERIDIAN, IN LAKE COUNTY, ILLINOIS.

#### PARCEL 3:

THAT PART OF THE NORTHEAST QUARTER OF SECTION 7 TOWNSHIP 46 NORTH, RANGE 12 EAST OF THE THIRD PRINCIPAL MERIDIAN DESCRIBED AS FOLLOWS: COMMENCING AT THE NORTHEAST CORNER OF SAID NORTHEAST QUARTER; THENCE WEST ALONG THE SECTION LINE TO THE EAST LINE OF THE WEST 75 ACRES OF SAID NORTHEAST QUARTER; THENCE SOUTH ALONG THE EAST LINE OF SAID WEST 75 ACRES, 1243 FEET (1243.43 FEET MEASURED); THENCE EAST 1402.5 FEET (1385.48 FEET MEASURED) TO THE SOUTHWEST CORNER OF FORMAN'S SUBDIVISION; THENCE NORTH 1244.04 FEET, MORE OR LESS, TO THE POINT OF BEGINNING (EXCEPT THAT PART OF THE ABOVE DESCRIBED PARCEL DESCRIBED AS FOLLOWS: BEGINNING AT THE NORTHWEST CORNER OF SECTION 8, ALSO BEING THE NORTHWEST CORNER OF LOT 4 IN FORMAN'S SUBDIVISION; THENCE SOUTH 0 DEGREES 21 MINUTES 58 SECONDS WEST ALONG THE WEST LINE OF SECTION 8, 609.95 FEET; THENCE SOUTH 89 DEGREES 38 MINUTES 02 SECONDS WEST, 180.0 FEET; THENCE NORTH 0 DEGREES 21 MINUTES 58 SECONDS WEST ON A LINE PARALLEL TO THE WEST LINE OF LOT 4, 370.30 FEET; THENCE WEST PARALLEL TO THE NORTH LINE OF THE NORTHEAST QUARTER OF SECTION 7, 34.50 FEET; THENCE NORTH 0 DEGREES 21 MINUTES 58 SECONDS WEST 241.25 FEET (241.39 FEET MEASURED), MORE OR LESS TO THE NORTH LINE OF SAID SECTION 7; THENCE EAST ALONG SAID NORTH LINE, 214.50 FEET, TO THE POINT OF BEGINNING), TOGETHER WITH THE WEST 75 ACRES OF THE NORTHEAST QUARTER OF SECTION 7, ALL IN TOWNSHIP 46 NORTH, RANGE 12 EAST OF THE THIRD PRINCIPAL MERIDIAN, IN LAKE COUNTY, ILLINOIS.

#### PARCEL 4:

THAT PART OF THE NORTHEAST QUARTER OF SECTION 7 AND OF THE NORTHWEST QUARTER OF SECTION 8, TOWNSHIP 46 NORTH, RANGE 12, EAST OF THE THIRD PRINCIPAL MERIDIAN, DESCRIBED AS FOLLOWS: TO--WIT; BEGINNING AT A POINT ON THE EAST LINE OF THE NORTHEAST QUARTER OF SECTION 7, AFORESAID, 75 1/3 RODS (1243 FEET), (1244.04 FEET MEASURED) SOUTH OF THE NORTH LINE OF SAID QUARTER SECTION; RUNNING THENCE WEST ON A LINE PARALLEL WITH THE NORTH LINE OF SAID QUARTER SECTION, 85 RODS (1402.5 FEET), (1385.48 FEET MEASURED); THENCE SOUTH ON A LINE PARALLEL WITH THE WEST LINE OF SAID QUARTER SECTION, 40 RODS (660 FEET), (658.85 FEET MEASURED); THENCE EAST ON A LINE PARALLEL WITH THE NORTH LINE AFORESAID, (1386.73 FEET MEASURED) TO 0 POINT ON THE EAST LINE OF SAID NORTHEAST QUARTER; THENCE NORTH ALONG THE EAST LINE OF THE NORTHEAST QUARTER OF SECTION 7, A DISTANCE OF 297.0 FEET, (297.23 FEET MEASURED); THENCE EAST PARALLEL WITH THE NORTH LINE OF SAID QUARTER SECTION FOR A DISTANCE OF (224.78 FEET MEASURED) TO THE WEST RIGHT--OF--WAY



LINE OF KENOSHA ROAD, 40 FEET DISTANT FROM THE CENTERLINE OF SAID ROAD; THENCE NORTH ALONG SAID WESTERLY RIGHT--OF--WAY LINE, A DISTANCE OF 354.37 FEET, MORE OR LESS, TO A POINT BEARING SOUTH 88 DEGREES 21 MINUTES 34 SECONDS EAST FROM THE POINT OF BEGINNING, ALSO BEING THE SOUTHEASTERLY CORNER OF LOT 1 IN FORMAN'S SUBDIVISION; THENCE NORTH 88 DEGREES 21 MINUTES 34 SECONDS WEST, 232.30 FEET, (233.31 FEET MEASURED), TO THE POINT OF BEGINNING, IN LAKE COUNTY, ILLINOIS.

PARCEL 5:

LOT 1, LOT 2, LOT 3 AND THE SOUTH 164 FEET OF LOT 4 (AS MEASURED ALONG THE WEST LINE THEREOF) ALL IN FORMAN'S SUBDIVISION, BEING A SUBDIVISION IN THE NORTHWEST QUARTER OF SECTION 8, TOWNSHIP 46 NORTH, RANGE 12, EAST OF THE THIRD PRINCIPAL MERIDIAN, ACCORDING TO THE PLAT THEREOF, RECORDED NOVEMBER 26, 1958, AS DOCUMENT NO. 1012214, IN BOOK 1666 OF RECORDS, PAGE 664, IN LAKE COUNTY, ILLINOIS.

PARCEL 6:

THE EAST FRACTIONAL HALF (EXCEPT THE WEST 50 RODS THEREOF) OF FRACTIONAL SECTION 6, TOWNSHIP 46 NORTH, RANGE 12, EAST OF THE THIRD PRINCIPAL MERIDIAN IN LAKE COUNTY, ILLINOIS.

PARCEL 7:

04-05-300-001

THAT PART OF FRACTIONAL SECTION 5, TOWNSHIP 46 NORTH, RANGE 12, EAST OF THE THIRD PRINCIPAL MERIDIAN, DESCRIBED AS FOLLOWS: COMMENCING AT THE NORTHWEST CORNER OF SAID FRACTIONAL SECTION 5; THENCE SOUTH ALONG THE WEST LINE OF SECTION 5, FOR A DISTANCE OF 284.12 FEET; THENCE EASTERLY ALONG A LINE PARALLEL WITH THE NORTH LINE OF SECTION 5 TO THE CENTER LINE OF KENOSHA ROAD; THENCE NORTHERLY ALONG THE CENTER LINE OF KENOSHA ROAD TO THE NORTH LINE OF SECTION 5; THENCE WEST ALONG THE NORTH LINE OF SECTION 5 TO THE PLACE OF BEGINNING, IN LAKE COUNTY, ILLINOIS.

PARCEL 8:

04-05-300-007

BEGINNING AT A POINT ON THE WEST LINE OF SAID FRACTIONAL SECTION 5, 758.8 FEET SOUTH OF THE NORTHWEST CORNER OF SAID FRACTIONAL SECTION 5; THENCE SOUTH ALONG SAID WEST LINE FOR A DISTANCE OF 535.0 FEET; THENCE EAST ALONG A LINE WHICH FORMS AN ANGLE OF 90 DEGREES 08 MINUTES WITH SAID WEST SECTION LINE, MEASURED FROM NORTH TO EAST FOR A DISTANCE OF 331.4 FEET TO THE CENTER LINE OF KENOSHA ROAD; THENCE NORTHERLY ALONG SAID CENTER LINE OF KENOSHA ROAD FOR A DISTANCE OF 535.0 FEET TO A POINT 754 FEET SOUTH, MEASURED ALONG SAID CENTERLINE, FROM THE NORTH LINE OF SAID FRACTIONAL SECTION 5; THENCE WEST 343.7 FEET TO THE POINT OF BEGINNING, (EXCEPT THE NORTH 130 FEET AND EXCEPT THE SOUTH 271.48 FEET THEREOF), IN LAKE COUNTY, ILLINOIS.

AND

04-05-300-008

THAT PART OF SECTION 5, TOWNSHIP 46 NORTH, RANGE 12 EAST OF THE THIRD PRINCIPAL MERIDIAN, LYING WEST OF THE PUBLIC HIGHWAY PARTICULARLY

DESCRIBED AS FOLLOWS TO-WIT: BEGINNING AT A POINT IN THE WEST LINE OF SAID SECTION 5, 758.8 FEET SOUTH OF THE CENTER OF THE STATE LINE ROAD, MARKED BY AN IRON PIPE RUNNING THENCE SOUTH ALONG AND UPON THE WEST LINE OF SAID SECTION 5, A DISTANCE OF 535 FEET; RUNNING THENCE EAST A DISTANCE OF 331.4 FEET, TO THE CENTER OF SAID PUBLIC HIGHWAY, KNOWN AS KENOSHA ROAD: RUNNING THENCE NORTHERLY ALONG THE CENTER OF SAID PUBLIC HIGHWAY A DISTANCE OF 535 FEET; THENCE RUNNING WEST A DISTANCE OF 343.7 FEET TO THE POINT OF BEGINNING (EXCEPT THE NORTH 260 FEET THEREOF AND EXCEPT THE SOUTH 136.48 FEET OF THE 535 FEET) IN LAKE COUNTY, ILLINOIS.

AND

04-05-300-009

THE SOUTH 136.48 FEET (MEASURED AT RIGHT ANGLES TO THE SOUTH LINE) OF THE FOLLOWING DESCRIBED TRACT OF LAND: THAT PART OF THE WEST HALF OF FRACTIONAL SECTION 5, TOWNSHIP 46 NORTH, RANGE 12, EAST OF THE THIRD PRINCIPAL MERIDIAN, DESCRIBED AS FOLLOWS: BEGINNING AT A POINT ON THE WEST LINE OF SAID FRACTIONAL SECTION 5, 758.8 FEET SOUTH OF THE NORTH WEST CORNER OF SAID FRACTIONAL SECTION 5; THENCE SOUTH ALONG SAID WEST SECTION LINE FOR A DISTANCE OF 535.00 FEET; THENCE EAST ALONG A LINE WHICH FORMS AN ANGLE OF 90 DEGREES 08 MINUTES WITH SAID WEST SECTION LINE, MEASURED FROM NORTH TO EAST FOR A DISTANCE OF 331.4 TO THE CENTER LINE OF KENOSHA ROAD; THENCE NORTHERLY ALONG SAID CENTER LINE OF KENOSHA ROAD FOR A DISTANCE OF 535.0 FEET TO A POINT 754.21 FEET SOUTH MEASURED ALONG SAID ROAD CENTER LINE, FROM THE NORTH LINE OF SAID FRACTIONAL SECTION 5; THENCE WEST 343.7 FEET TO THE POINT OF BEGINNING, IN LAKE COUNTY, ILLINOIS.

AND

04-05-300-010

THE SOUTH 2 ACRES OF THE FOLLOWING DESCRIBED PREMISES (TAKEN AS A TRACT) TO WIT: THAT PART OF LOTS 1 AND 2 IN THE WEST HALF OF SECTION 5, TOWNSHIP 46 NORTH, RANGE 12, EAST OF THE THIRD PRINCIPAL MERIDIAN, LYING WEST OF THE CENTER LINE OF THE PUBLIC HIGHWAY (EXCEPT THE SOUTH 65 RODS AND 5 LINKS THEREOF) IN LAKE COUNTY, ILLINOIS.

AND

04-05-300-022

THE NORTH 157.3 FEET OF THAT PART OF THE WEST FRACTIONAL HALF OF SECTION 5, TOWNSHIP 46 NORTH, RANGE 12, EAST OF THE THIRD PRINCIPAL MERIDIAN, DESCRIBED AS FOLLOWS: COMMENCING AT THE SOUTH WEST CORNER OF SAID WEST FRACTIONAL HALF OF SECTION 5, AND RUNNING THENCE NORTH ALONG THE WEST LINE OF SAID SECTION, 65 RODS AND 15 LINKS (1,082.4 FEET); THENCE EAST 19 RODS AND 15 LINKS (323.4 FEET); THENCE SOUTH 1 DEGREE 25 MINUTES WEST TO THE SOUTH LINE OF SAID SECTION, THENCE WEST ON THE SOUTH LINE OF SAID SECTION TO THE PLACE OF BEGINNING, EXCEPT THE EAST 40 FEET THEREFOR TAKEN FOR ROADWAY PURPOSES PER DOCUMENT NUMBER 1324145 IN LAKE COUNTY, ILLINOIS.

AND

04-05-300-023

THE SOUTH 157.3 FEET OF THE NORTH 314.6 FEET OF THAT PART OF THE WEST FRACTIONAL HALF OF SECTION 5, TOWNSHIP 46 NORTH, RANGE 12, EAST OF THE THIRD PRINCIPAL MERIDIAN, DESCRIBED AS FOLLOWS: COMMENCING AT THE SOUTHWEST CORNER OF SAID WEST FRACTIONAL HALF OF SECTION 5, AND RUNNING THENCE NORTH ALONG THE WEST LINE OF SAID SECTION, 65 RODS AND 15 LINKS (1082.4 FEET); THENCE EAST 19 RODS AND 15 LINKS (323.4 FEET); THENCE SOUTH 1 DEGREE 25 MINUTES WEST TO THE SOUTH LINE OF SAID SECTION; THENCE WEST ON THE SOUTH LINE OF SAID SECTION TO THE PLACE OF BEGINNING, IN LAKE COUNTY, ILLINOIS.

AND

04-05-300-012

(EXCEPT THE NORTH 314.6 FEET) THAT PART OF THE WEST FRACTIONAL HALF OF SECTION 5, TOWNSHIP 46 NORTH, RANGE 12, EAST OF THE THIRD PRINCIPAL MERIDIAN, DESCRIBED AS FOLLOWS: COMMENCING AT THE SOUTHWEST CORNER OF SAID FRACTIONAL HALF OF SAID SECTION 5, AND RUNNING THENCE NORTH ON THE WEST LINE OF SAID SECTION, 65 RODS AND 15 LINKS (1082.4 FEET); THENCE EAST 19 RODS AND 15 LINKS (323.4 FEET); THENCE SOUTH 1 DEGREE AND 25 MINUTES WEST TO THE SOUTH LINE OF SAID SECTION, AND THENCE WEST ALONG THE SOUTH LINE OF SAID SECTION TO THE POINT OF BEGINNING, IN LAKE COUNTY, ILLINOIS

PARCEL 9:

04-07-200-011

THAT PART OF THE NORTHEAST QUARTER OF THE NORTHEAST QUARTER OF SECTION 7, TOWNSHIP 46 NORTH, RANGE 12, EAST, OF THE THIRD PRINCIPAL MERIDIAN, DESCRIBED AS FOLLOWS: BEGINNING AT THE NORTHEAST CORNER OF THE NORTHEAST QUARTER OF THE NORTHEAST QUARTER; THENCE SOUTH ALONG THE EAST LINE OF SAID SECTION 7, 154.0 FEET; THENCE WEST ALONG THE NORTH LINE OF A CERTAIN PARCEL 2 OF A PLAT OF DEDICATION RECORDED JUNE 18, 1974, AS DOCUMENT No. 1668365, IN BOOK 53 OF PLATS, PAGE 66, 7.65 FEET; THENCE SOUTHWESTERLY ALONG THE NORTHWESTERLY LINE OF SAID PARCEL 2, 192.41 FEET; THENCE WEST PARALLEL TO THE NORTH LINE OF SAID SECTION 7; THENCE EAST ALONG SAID NORTH LINE 215.5 FEET TO THE POINT OF BEGINNING, ALL IN LAKE COUNTY, ILLINOIS.

AND

04-08-101-001

THE NORTH 154 FEET OF LOT 4 IN FORMAN'S SUBDIVISION, BEING A SUBDIVISION IN THE NORTHWEST QUARTER OF SECTION 8, TOWNSHIP 46 NORTH, RANGE 12, EAST OF THE THIRD PRINCIPAL MERIDIAN, ACCORDING TO THE PLAT THEREOF, RECORDED NOVEMBER 26, 1958, AS DOCUMENT No. 1012214, IN BOOK 1666 OF RECORDS, PAGE 664, IN LAKE COUNTY, ILLINOIS.



Attachment to Question 7

Horizontal waste disposal unit boundaries are set forth in the attached legal description of the waste boundary. Horizontal waste disposal unit boundaries were presented in Appendix D of the Siting Application provided to the Zion City Council.

Bottom vertical waste disposal unit boundaries are set forth in the attached Drawing No. D10 – Proposed Leachate Collection System Layer Grades, provided as part of the Design Drawings within the Siting Application.

Top vertical waste disposal unit boundaries are set forth in the attached Drawing No. D11 – Proposed Final Landform Grades, provided as part of the Design Drawings within the Siting Application (the top vertical waste disposal unit boundary would be approximately five (5) feet lower than the final landform grades).

## ZION LANDFILL SITE 2 NORTH EXPANSION

### LEGAL DESCRIPTION OF EXPANDED WASTE BOUNDARY

#### DESCRIPTION OF LIMITS OF WASTE WITHIN SITE 2 NORTH EXPANSION

THAT PART OF THE NORTHEAST QUARTER OF SECTION 7, AND THAT PART OF THE EAST FRACTIONAL SECTION 6, TOWNSHIP 46 NORTH, RANGE 12, EAST OF THE THIRD PRINCIPAL MERIDIAN, DESCRIBED AS FOLLOWS: COMMENCING AT THE NORTHWEST CORNER OF THE NORTHEAST QUARTER OF SECTION 7; THENCE SOUTH 00 DEGREES 02 MINUTES 42 SECONDS WEST, 162.62 FEET; THENCE NORTH 72°55'16" EAST, 38.86 FEET; THENCE SOUTH 89°4.5'56" EAST, 1009.04 FEET TO THE POINT OF BEGINNING OF THE PARCEL HEREIN INTENDED TO BE DESCRIBED; THENCE NORTH 05°13'41" EAST, 100.22 FEET; THENCE NORTH 01°14'02" EAST, 1647.28 FEET; THENCE NORTH 46°14'09" EAST, 768.60 FEET; THENCE SOUTH 88°45'51" EAST, 691.80 FEET; THENCE SOUTH 05°49'01" EAST, 502.39 FEET; THENCE SOUTH 01°04'44" EAST 2048.29 FEET, TO A POINT ON A CURVE; THENCE NORTHWESTERLY ALONG A CURVED LINE CONCAVE TO THE SOUTHWEST HAVING A RADIUS OF 280.00 FEET, AN ARC LENGTH OF 109.72 FEET AND A CHORD LENGTH OF 109.02 FEET BEARING NORTH 11 DEGREES 10 MINUTES 51 SECONDS WEST TO A POINT OF COMPOUND CURVATURE; THENCE NORTHWESTERLY ALONG A CURVED LINE CONCAVE TO THE SOUTHWEST HAVING A RADIUS OF 280.00 FEET, AN ARC LENGTH OF 214.95 FEET AND A CHORD LENGTH OF 209.71 FEET BEARING NORTH 44 DEGREES 23 MINUTES 57 SECONDS WEST TO A POINT OF COMPOUND CURVATURE; THENCE SOUTHWESTERLY ALONG A CURVED LINE CONCAVE TO THE SOUTHEAST HAVING A RADIUS OF 20.00 FEET, AN ARC LENGTH OF 18.04 FEET AND A CHORD LENGTH OF 17.43 FEET BEARING SOUTH 87 DEGREES 46 MINUTES 05 SECONDS WEST TO A POINT OF TANGENCY; THENCE SOUTH 61 DEGREES 55 MINUTES 47 SECONDS WEST, 108.93 FEET TO A POINT OF CURVATURE; THENCE SOUTHWESTERLY ALONG A CURVED LINE CONCAVE TO THE NORTHWEST HAVING A RADIUS OF 68.00 FEET, AN ARC LENGTH OF 34.40 FEET, AND A CHORD LENGTH OF 34.03 FEET BEARING SOUTH 76 DEGREES 25 MINUTES 20 SECONDS WEST TO A POINT OF TANGENCY; THENCE NORTH 89 DEGREES 05 THE MINUTES 00 THE SECONDS WEST, 34.49 FEET TO A POINT OF CURVATURE; THENCE NORTHWESTERLY ALONG A CURVED LINE CONCAVE TO THE NORTHEAST HAVING A RADIUS OF 68.00 FEET, AN ARC LENGTH OF 46.36 FEET AND A CHORD LENGTH OF 45.47 FEET BEARING NORTH 69 DEGREES 33 MINUTES 08 SECONDS WEST TO A POINT OF TANGENCY; THENCE NORTH 50 DEGREES 01 MINUTES 05" SECONDS WEST, 98.15 FEET TO A POINT OF CURVATURE; THENCE NORTHWESTERLY ALONG A CURVED LINE CONCAVE TO THE SOUTHWEST HAVING A RADIUS OF 20.00 FEET, AN ARC LENGTH OF 13.87 FEET AND A CHORD LENGTH OF 13.59 FEET BEARING NORTH 69 DEGREES 53 MINUTES 07 SECONDS WEST TO A POINT OF TANGENCY; THENCE NORTH 89 DEGREES 45 MINUTES 56 SECONDS WEST, 829.13 FEET TO THE POINT OF BEGINNING, ALL IN LAKE COUNTY, ILLINOIS.

(CONTAINING 62.2 ACRES, MORE OR LESS)

#### DESCRIPTION OF LIMITS OF WASTE WITHIN PERMITTED ZION LANDFILL

THAT PART OF THE NORTHEAST QUARTER OF SECTION 7, AND OF THE NORTHWEST QUARTER OF SECTION 7, TOWNSHIP 46 NORTH, RANGE 12, EAST OF THE THIRD PRINCIPAL MERIDIAN, DESCRIBED AS FOLLOWS: COMMENCING AT THE NORTHEAST

CORNER OF THE NORTHWEST QUARTER OF SECTION 7; THENCE SOUTH 00 DEGREES 42 MINUTES 09 SECONDS WEST, 76.18 FEET TO THE POINT OF BEGINNING OF THE PARCEL HEREIN INTENDED TO BE DESCRIBED; THENCE NORTH 89 DEGREES 56 MINUTES 10 SECONDS WEST, 1299.39 FEET; THENCE SOUTH 00 DEGREES 09 MINUTES 13 SECONDS EAST 2057.94 FEET; THENCE NORTH 89 DEGREES 59 MINUTES 52 SECONDS EAST, 1293.88 FEET; THENCE NORTH 00 DEGREES 00 MINUTES 00 SECONDS EAST, 42.05 FEET; THENCE SOUTH 89 DEGREES 56 MINUTES 18 SECONDS EAST, 955.58 FEET TO A POINT OF CURVATURE; THENCE NORTHEASTERLY ALONG A CURVED LINE CONCAVE TO THE NORTHWEST HAVING A RADIUS OF 150.00 FEET, AN ARC LENGTH OF 236.2 FEET, AND A CHORD LENGTH OF 212.70 FEET BEARING NORTH 44 DEGREES 54 MINUTES 29 SECONDS EAST TO A POINT OF TANGENCY; THENCE NORTH 00 DEGREES 19 MINUTES 09 SECONDS EAST, 80.36 FEET TO A POINT OF CURVATURE; THENCE NORTHEASTERLY ALONG A CURVED LINE CONCAVE TO THE SOUTHEAST HAVING A RADIUS OF 150.00 FEET, AN ARC LENGTH OF 221.56 FEET AND A CHORD LENGTH OF 201.96 FEET BEARING NORTH 47 DEGREES 57 MINUTES 42 SECONDS EAST TO A POINT OF TANGENCY; THENCE SOUTH 89 DEGREES 43 MINUTES 23 SECONDS EAST, 800.12 FEET TO A POINT OF CURVATURE; THENCE NORTHEASTERLY ALONG A CURVED LINE CONCAVE TO THE NORTHWEST HAVING A RADIUS OF 150.00 FEET, AN ARC LENGTH OF 109.91 FEET AND A CHORD LENGTH OF 107.47 FEET, BEARING NORTH 69 DEGREES 17 MINUTES 10 SECONDS EAST TO A POINT OF TANGENCY; THENCE NORTH 48 DEGREES 17 MINUTES 43 SECONDS EAST, 198.33 FEET TO A POINT OF CURVATURE; THENCE NORTHWESTERLY ALONG A CURVED LINE CONCAVE TO THE NORTHWEST HAVING A RADIUS OF 150.00 FEET, AN ARC LENGTH OF 126.44 FEET AND A CHORD LENGTH OF 122.73 FEET BEARING NORTH 24 DEGREES 08 MINUTES 52 SECONDS EAST TO A POINT OF TANGENCY; THENCE NORTH 00 DEGREES 00 MINUTES 00 SECONDS EAST, 1009.36 FEET TO A POINT OF CURVATURE; THENCE NORTHWESTERLY ALONG A CURVED LINE CONCAVE TO THE SOUTHWEST HAVING A RADIUS OF 280.00 FEET, AN ARC LENGTH OF 109.72 FEET AND A CHORD LENGTH OF 109.02 FEET BEARING NORTH 11 DEGREES 13 MINUTES 55 SECONDS WEST TO A POINT OF COMPOUND CURVATURE; THENCE NORTHWESTERLY ALONG A CURVED LINE CONCAVE TO THE SOUTHWEST HAVING A RADIUS OF 280.00 FEET, AN ARC LENGTH OF 214.95 FEET AND A CHORD LENGTH OF 209.71 FEET BEARING NORTH 44 DEGREES 26 MINUTES 43 SECONDS WEST TO A POINT OF COMPOUND CURVATURE; THENCE SOUTHWESTERLY ALONG A CURVED LINE CONCAVE TO THE SOUTHEAST HAVING A RADIUS OF 20.00 FEET, AN ARC LENGTH OF 18.04 FEET AND A CHORD LENGTH OF 17.43 FEET BEARING SOUTH 87 DEGREES 43 MINUTES 24 SECONDS WEST TO A POINT OF TANGENCY; THENCE SOUTH 61 DEGREES 53 MINUTES 05 SECONDS WEST 108.93 FEET TO A POINT OF CURVATURE; THENCE SOUTHWESTERLY ALONG A CURVED LINE CONCAVE TO THE NORTHWEST HAVING A RADIUS OF 68.00 FEET, AN ARC LENGTH OF 34.40 FEET, AND A CHORD LENGTH OF 34.04 FEET BEARING SOUTH 76 DEGREES 22 MINUTES 41 SECONDS WEST TO A POINT OF TANGENCY; THENCE NORTH 89 DEGREES 07 MINUTES 42 SECONDS WEST, 34.49 FEET TO A POINT OF CURVATURE; THENCE NORTHWESTERLY ALONG A CURVED LINE CONCAVE TO THE NORTHEAST HAVING A RADIUS OF 68.00 FEET, AN ARC LENGTH OF 46.36 FEET AND A CHORD LENGTH OF 45.47 FEET BEARING NORTH 69 DEGREES 35 MINUTES 44 SECONDS WEST TO A POINT OF TANGENCY; THENCE NORTH 50 DEGREES 03 MINUTES 47 SECONDS WEST, 98.15 FEET TO A POINT OF CURVATURE; THENCE NORTHWESTERLY ALONG A CURVED LINE CONCAVE TO THE SOUTHWEST HAVING A

RADIUS OF 20.00 FEET, AN ARC LENGTH OF 13.87 FEET AND A CHORD LENGTH OF 13.60 FEET BEARING NORTH 69 DEGREES 56 MINUTES 12 SECONDS WEST TO A POINT OF TANGENCY; THENCE NORTH 89 DEGREES 48 MINUTES 38 SECONDS WEST, 1838.17 FEET; THENCE SOUTH 72 DEGREES 52 MINUTES 34 SECONDS WEST, 38.86 FEET; THENCE NORTH 00 DEGREES 00 MINUTES WEST, 86.44 FEET TO THE POINT OF BEGINNING, ALL IN LAKE COUNTY, ILLINOIS.

(CONTAINING 154.1 ACRES, MORE OR LESS)



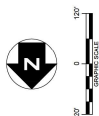
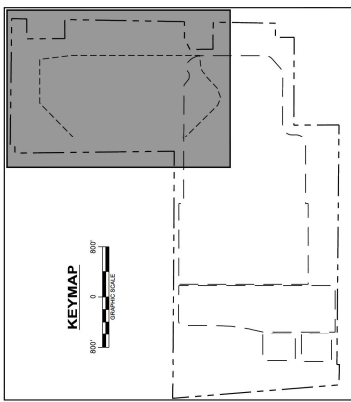

- LEGEND**
- APPROXIMATE FACILITY BOUNDARY
  - - - APPROXIMATE EXISTING WASTE BOUNDARY
  - - - APPROXIMATE PROPOSED EXPANSION WASTE BOUNDARY
  - EXISTING CONTOUR
  - EXISTING ROAD
  - EXISTING VEGETATION
  - EXISTING FENCE
  - EXISTING CULVERT
  - PROPOSED GROUND SURFACE ELEVATION CONTOUR (FEET MSL)
  - PROPOSED ROAD
  - EXISTING FORCEMAIN
  - EXISTING LEACHATE COLLECTION PIPE
  - EXISTING LEACHATE CLEANOUT LOCATION
  - EXISTING LEACHATE VAULT LOCATION
  - EXISTING LEACHATE COLLECTION SUMP LOCATION
  - PROPOSED FORCEMAIN
  - PROPOSED LEACHATE COLLECTION PIPE
  - PROPOSED LEACHATE CLEANOUT LOCATION
  - PROPOSED LEACHATE VAULT/MANHOLE LOCATION
  - PROPOSED LEACHATE COLLECTION SUMP LOCATION

- NOTES**
1. EXISTING CONTOURS DERIVED FROM SITE AERIAL TOPOGRAPHIC SURVEY BY COAM, INC. ON 10/22/2018 EXCEPT STORMWATER MANAGEMENT FEATURES WHICH WERE CONSTRUCTED TO BE A MINIMUM ONE FOOT THICK ABOVE THE EXISTING GROUND SURFACE. THE LEACHATE COLLECTION SYSTEM WITH THESE COLLECTOR GRADES ARE SHOWN FOR THESE FEATURES FOR COMPLETENESS, AS NOT ALL GRADES ARE CAPTURED BY THE TOPOGRAPHIC SURVEY.
  2. FOR CLARITY, NOT ALL SITE FEATURES MAY BE SHOWN.
  3. CURRENT TOPOGRAPHY MAY DIFFER FROM THAT SHOWN.
  4. THE LEACHATE COLLECTION PIPING SHOWN FOR THE EXISTING LANDFILL WAS CONSTRUCTED TO BE A MINIMUM ONE FOOT THICK ABOVE THE EXISTING GROUND SURFACE. THE LEACHATE COLLECTION SYSTEM WITH THESE COLLECTOR GRADES ARE SHOWN FOR THESE FEATURES FOR COMPLETENESS, AS NOT ALL GRADES ARE CAPTURED BY THE TOPOGRAPHIC SURVEY.
  5. THE TOP OF PROPOSED LEACHATE COLLECTION PIPES ARE SHOWN FOR THE SITE 2 NORTH HORIZONTAL EXPANSION AREA (CELLS 11 THROUGH 17).
  6. THE LEACHATE COLLECTION LAYER SHALL BE A MINIMUM 1-FOOT THICK ABOVE THE CONSTRUCTED TOP OF EXCAVATION GRADES.
  7. THE EXISTING AND PROPOSED LEACHATE FORCEMAIN MAY BE LOCATED INSIDE DEFLECTED ON THIS DRAWING. CARE OF SLOPE IN LIEU OF CUT/SLOPE AS SHOWN.
  8. CELL DEVELOPMENT WILL PROCEED IN NUMERICAL ORDER. VERTICAL EXPANSION WILL PROCEED CONCURRENT WITH CELL 11 DEVELOPMENT.
  9. EXISTING LEACHATE FORCEMAIN AND LANDOUT FACILITY IN VERTICAL EXPANSION DURING CELL 11 DEVELOPMENT. REINFORCED AS PART OF PROPOSED DETAIL 3019. LEACHATE WILL BE SAMPLED AT EACH MANHOLE LOCATION.

**SECTIONS AND DETAIL KEY**

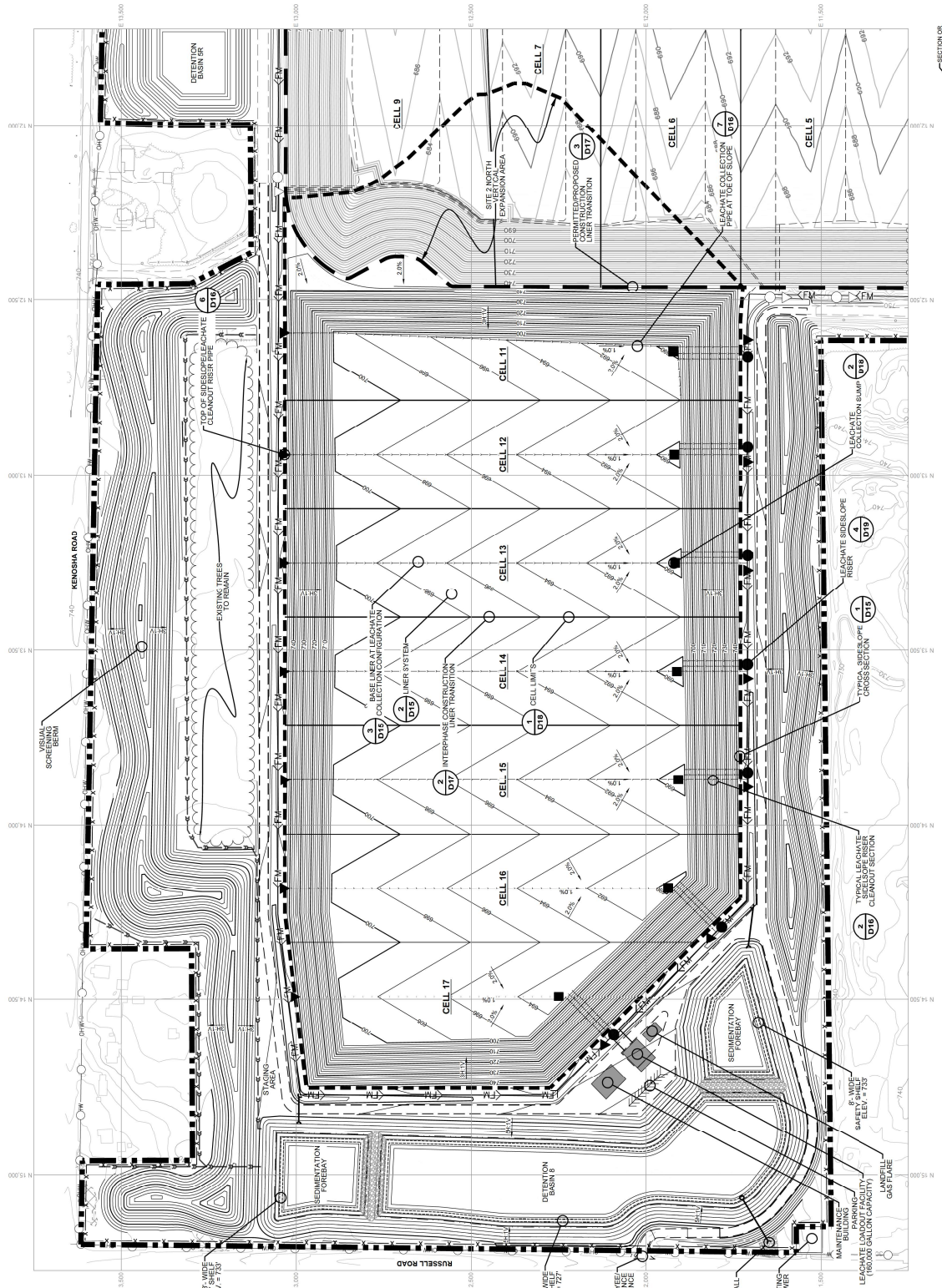

PROJ. NO.:	631020106	DATE:	AUGUST 2021
DESIGNED BY:	DAM/BNW	DRAWING NO.:	<b>D10</b>
DRAWN BY:	BNW/JN	DAM	10 OF 29 SHEETS
CHECKED BY:	DAM	APPROVED BY:	DAM

**ZION LANDFILL - SITE 2 NORTH EXPANSION  
CITY OF ZION, ILLINOIS  
PROPOSED LEACHATE COLLECTION  
SYSTEM LAYER GRADES**

**APTIM Environmental & Infrastructure, LLC**

**APTIM**

**GREEN FOR LIFE**  
INVESTING IN BETTER

REV. NO.	DATE	DESCRIPTION

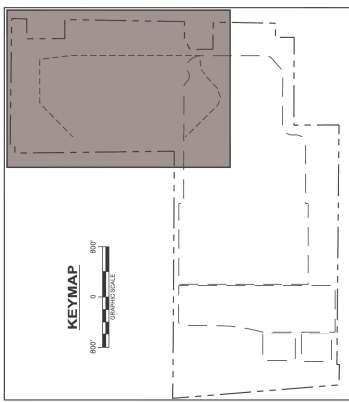

- LEGEND**
- APPROXIMATE FACILITY BOUNDARY
  - APPROXIMATE EXISTING WASTE BOUNDARY
  - WASTE BOUNDARY
  - EXISTING CONTOUR
  - EXISTING ROAD
  - EXISTING VEGETATION
  - EXISTING FENCE
  - EXISTING POWER POLE
  - EXISTING OVERHEAD WIRE
  - EXISTING CULVERT
  - PROPOSED CONTOUR
  - PROPOSED ROAD
  - PROPOSED PERIMETER FENCE
  - PROPOSED CULVERT
  - PROPOSED DRAIN TILE

**NOTES**

1. EXISTING CONTOURS DEVELOPED FROM SITE AERIAL TOPOGRAPHIC SURVEY PROVIDED BY COM, INC. ON 10/22/2018 EXCEPT FOR THE CONTOURS OF THE DETENTION BASIN. THE EAST DITCHES AND BASIN (RA) STORMWATER DESIGN GRADES ARE SHOWN FOR THESE FEATURES FOR COMPLETENESS, AS NOT ALL GRADES ARE OBTAINED BY THE TOPOGRAPHIC SURVEY.
2. FOR CLARITY, NOT ALL SITE FEATURES MAY BE SHOWN.
3. CURRENT TOPOGRAPHY MAY DIFFER FROM THAT SHOWN.
4. TOP OF PERMITTED FINAL COVER GRADES ARE SHOWN FOR THE EXISTING LANDFILL (CELLS 6, 7, AND 9), WITH THE EXCEPTION OF THE SITE NORTH VERTICAL EXPANSION AREA.
5. THE TOP OF PROPOSED FINAL COVER GRADES ARE SHOWN FOR THE PROPOSED VERTICAL EXPANSION AREA. THE PROPOSED VERTICAL EXPANSION AREA FINAL COVER GRADES WILL BE SHOWN AS SHOWN IN THE ATTACHED DETAIL DRAWING FOR THE LANDFILL AS SHOWN.
6. THE FINAL COVER WILL BE CONSTRUCTED TO BE A MINIMUM FIVE-FOOT THICK.



SECTION OR DETAIL LABEL  
DRAWING ON WHICH THIS SECTION IS SHOWN

SECTIONS AND DETAIL KEY

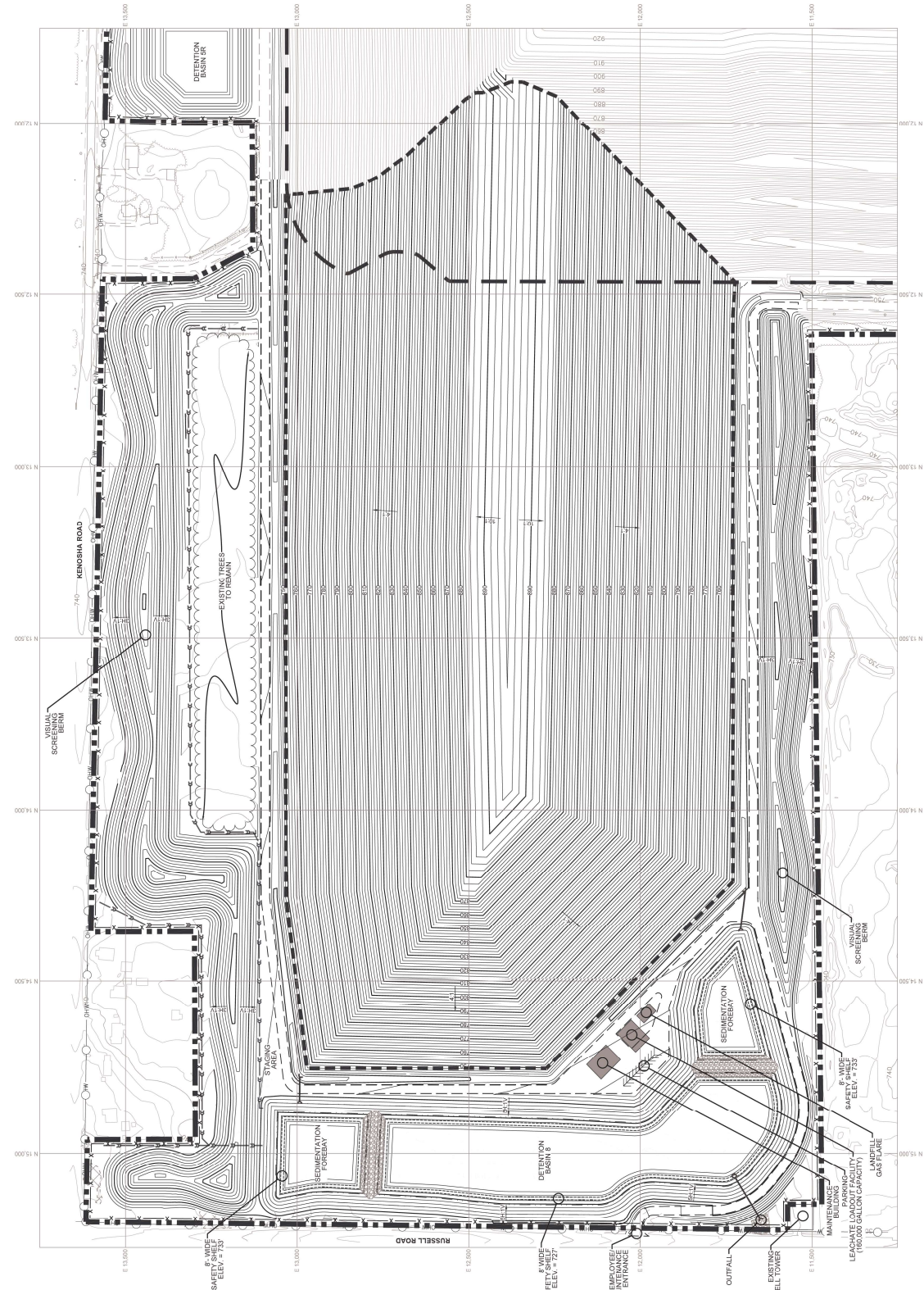

<p><b>ZION LANDFILL - SITE 2 NORTH EXPANSION</b> CITY OF ZION, ILLINOIS</p> <p><b>PROPOSED FINAL LANDFORM GRADES</b></p>	<p>PROJ. NO.: 631020106 DATE: AUGUST 2021</p> <p>DESIGNED BY: DAM/BNW DRAWING NO. <b>D11</b></p> <p>DRAWN BY: BMW/JN</p> <p>CHECKED BY: DAM</p> <p>APPROVED BY: DAM</p>	<p>11 OF 29 SHEETS</p>												
	<p><b>APTIM Environmental &amp; Infrastructure, LLC</b></p> <p><b>APTIM</b></p> <p><b>GREEN FOR LIFE</b> INVESTMENT PARTNER</p>													
<table border="1"> <thead> <tr> <th>REV. NO.</th> <th>DATE</th> <th>DESCRIPTION</th> </tr> </thead> <tbody> <tr> <td> </td> <td> </td> <td> </td> </tr> <tr> <td> </td> <td> </td> <td> </td> </tr> <tr> <td> </td> <td> </td> <td> </td> </tr> </tbody> </table>	REV. NO.	DATE	DESCRIPTION										<p>APTIM Environmental &amp; Infrastructure, LLC 1111 W. WASHINGTON ST., SUITE 200, CHICAGO, IL 60606 www.aptim.com All rights reserved. No part of this publication may be reproduced, stored in a retrieval system, or transmitted, in any form or by any means, without express written permission from APTIM Environmental &amp; Infrastructure, LLC.</p>	
REV. NO.	DATE	DESCRIPTION												

Attachment to Question 6

The attached ordinance is provided as a record of local siting approval from the Zion City Council for the Zion Landfill Site 2 North Expansion. The specific conditions imposed on Zion Landfill, Inc. are set forth in the ordinance.



# Illinois Environmental Protection Agency

Bureau of Land • 1021 N. Grand Avenue E. • Box 19276 • Springfield • Illinois • 62794-9276

## Notice of Application for Permit to Manage Waste (LPC-PA16)

Date: July 18, 2022

### To Elected Officials and Concerned Citizens:

The purpose of this notice is to inform you that a permit application has been submitted to the Illinois EPA, Bureau of Land, for a solid waste project described below. You are not obligated to respond to this notice, however, if you have any comments, please submit them in writing to the Bureau of Land, Attn: Permit Section, at the above address, or contact the Permit Section at 217/524-3300 within 21 days.

**NOTE: Please complete this form online, save a copy locally, print and submit it to the Permit Section #33, at the above.**

The permit application, which is identified below, is for a project described at the bottom of this page.

### Site Identification:

Site Name: Zion Landfill IEPA ID Number: 0978020002

Street Address: 701 Green Bay Road P.O. Box: \_\_\_\_\_

City: Zion State: IL Zip Code: 60099-9564 County: Lake

### TYPE OF PERMIT SUBMISSIONS:

### TYPE OF FACILITY:

### TYPE OF WASTE:

- New Landfill
- Landfill Expansion
- First Significant Modification
- Significant Modification to Operate
- Other Significant Modification
- Renewal of Landfill
- Development
- Operating
- Supplemental
- Transfer
- Name Change
- Generic

- Landfill
- Land Treatment
- Transfer Station
- Treatment Facility
- Storage
- Incinerator
- Composting
- Recycling/Reclamation
- Other (Specify)

- General Municipal Refuse
- Hazardous
- Special (Non-Hazardous)
- Chemical Only (exec. putrescible)
- Inert Only (exec. chem. & putrescible)
- Used Oil
- Solvents
- Landscape/Yard Waste
- Other (Specify)

### Description of Project:

Vertical and horizontal expansion of the existing Zion Landfill.

\_\_\_\_\_

\_\_\_\_\_

This Agency is authorized to require this information under Section 4 and Title X of the Environmental Protection Act (415 ILCS 5/4, 5/39). Failure to disclose this information may result in: a civil penalty of not to exceed \$50,000 for the violation and an additional civil penalty of not to exceed \$10,000 for each day during which the violation continues (415 ILCS 5/42). This form has been approved by the Forms Management Center.